

FUTURENT[®]

ENT treatment unit

The total solution for the simplification
of ENT consulting room procedures



FUTURENT[®]

Based on a long line of ENT treatment units, the Futurent[®] ENT treatment unit is ergonomically designed to simplify ENT procedures and improve efficiency in the ENT consulting room. Metal, timber and other materials are combined to form the basis of an efficient, durable and patient-friendly setting. State-of-the-art electronics help optimise efficiency and minimise downtime. Modular furniture can be added to the Futurent[®], in accordance with particular requirements, available space and budget, to create a professional ENT suite.

- Superb ergonomics for improved efficiency
- Wide selection of integrated functions
- State-of-the-arts electronics
- Elegant design with curved front panels
- Maintenance friendly system
- Generous instrument space
- On-screen info helps reduce downtime
- Customised in accordance with specific requirements and budget
- Mobile on castors or fitted as a fixture



Metal Therapy Section



Incorporates:

- Electronics with microprocessor
- Control console and illuminated LCD
- 6 handpiece holders
- 10 buttons for external equipment
- Tidy cable and hose storage

Metal therapy section can be positioned for convenient access to handpieces

Timber Instrumentation Section



Incorporates:

- Dual level worktop
- Two illuminated instrument trays with stainless steel dividers located beneath upper worktop
- Two storage drawers with adjustable dividers
- Two large drawers with openings for waste disposal and used instruments

Worktop available in two finishes:

- Marlan - luxury synthetic granite
- Thermopal - durable and scratch resistant





Futurent® control console

Unique features of advanced electronics

This system incorporates a sophisticated microprocessor with embedded software. Useful information can be accessed via the menus on LCD display. When the ENT Diagnostic Centre is coupled to the electronics, a choice of diagnostic modules and digital imaging components can be included in the configuration.

- Microprocessor with LCD display
- Diagnostic centre can be coupled
- Suction use counter
- Fibre optic light use counter
- Compressed air use counter
- Endoscopy counter
- Total use time counter
- Fault diagnosis programme
- Service due indicator
- Energy save mode

The Futurent® can be equipped with a wide selection of integrated functions to accommodate specific requirements and budget. Certain integrated functions are automatically activated by means of sensors when the handpieces are removed from their holders. Others can be controlled via the console and LCD display.

Integrated functions by choice

- Suction system (automatically activated)
- Rinsing facility for hose and secretion receptacle Automatic secretion discharge (not for mobile treatment units)
- Small basin with irrigation for clearing blocked suction tubes

- Compressed air c/w atomizers (automatically activated)
- Fibre optic light source for rigid and flexible endoscopes (automatically activated)
- Fibre optic light source with switchable hook for examination headlight
- Cordless examination headlight with battery charger integrated on treatment unit
- Warm water irrigator
- Mirror preheater rack for up to 60 mirrors
- Hot air mirror heater (automatically switches off after 3 seconds)
- Heated or non-heated rigid telescope holders
- Flexible scope holder
- Cautery power sockets (standard item always included in configuration)
- Low voltage power source (standard item always included in configuration)
- Examination microscope (not for mobile treatment units)

Options for ENT Diagnostic Centre

- Video endoscopy imaging system with video camera
- 17" TFT monitor or touch screen TFT monitor for above
- LED stroboscope (doubles as light source for endoscopes)
- Rhinomanometer pc based module*
- Tympanometer pc based module*
- Sinus echography pc based module*

*Diagnostic Centre must be included in the configuration to integrate these devices.

ENT Diagnostic Centre

This integral system communicates with the microprocessor in the Futurent® via interface software, making it possible to add additional functions to treatment unit's configuration, such as a video endoscopy system with a choice of imaging software and choice of three diagnostic modules. The interface software has a useful feature of its own – ear, nose and throat images can be selected from the control console for use in patient explanations. The computer includes MS Windows software. A remote DVD driver/writer and USB connection are fitted in the treatment unit within easy reach of the user.

Medgrabber Lite® imaging software



- Digital online zooming of images
- Convenient foot control for capturing and saving images and video footage to disk
- Large image size
- Excellent image quality
- User friendly software

Medgrabber Lite® starts up automatically when the camera head is removed from its holder on the front of the Futurent® treatment unit.

This opens the door to an array of other possibilities such as the transfer of digital images and information via computer network or the Internet. The camera head activates the imaging software when it is removed from its holder and the video image automatically appears on the monitor making this system extremely

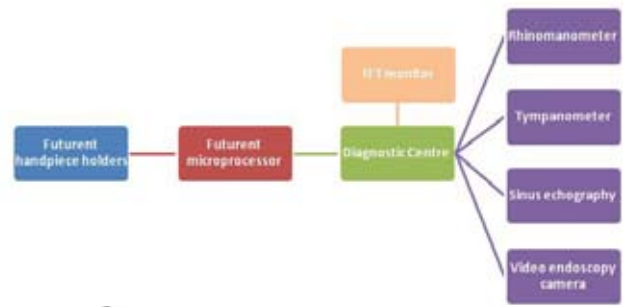

user friendly. When the camera head is replaced in its holder, the software also closes automatically.

Other imaging/patient management software packages are available for connection to the HIS (or PACS) via HL7 interface (Dicom compatible).

Alongside the video endoscopy possibilities, three pc based diagnostic modules are available for use with the Diagnostic Centre.



Rhinomanometry



Tympanometry



Sinus echography

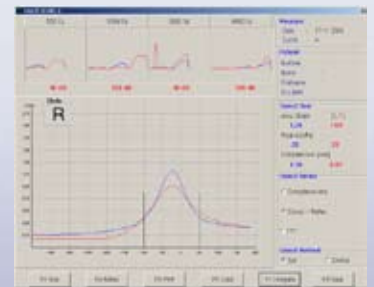

Software

The diagnostic modules start up automatically when the probes are removed from their holders on the Futurent® treatment unit. The diagnostic software is operated from the treatment unit's control console and LCD, practically eliminating the requirement for a mouse and keyboard.

Modular furniture



Futurent® pictured with desk section, washbasin section, L-form writing desk, examination microscope, wall cupboards, patient chair and doctor stool

The Futurent can be combined with a selection of matching furniture in a variety of colours and styles to form a complete ENT suite. This further improves efficiency and gives the consulting room a professional ambience.

Entered treatment units and complementary modular furniture are hand built to the highest standards, according to the client's specifications and requirements, at Entered's facility in the Netherlands.

On request, the company's designers can produce a proposed plan of the consulting room, illustrating the recommended position of the treatment unit, modular furniture and patient chair in relation to windows and doorways to ensure maximum efficiency.

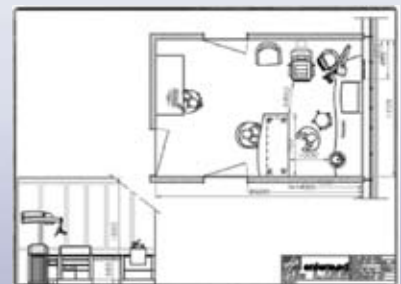

Modular furniture

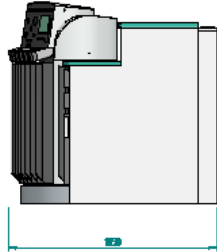
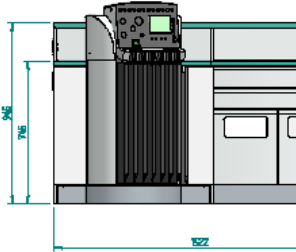
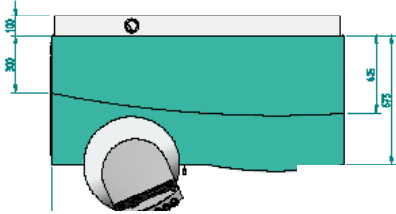

980800/H FUTURENT® ENT Treatment Unit

980800/H/MAR As above with Marlan worktop.

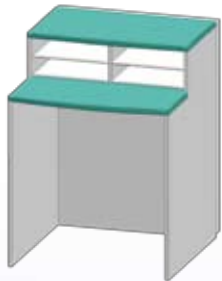

980820/H Desk section with Thermopop worktop Length: 710 mm

980820/H/MAR As above with Marlan worktop



980810/H As above with integrated drawers with Thermopop worktop
 Dossier niche
 Integrated drawers, 1 large and 3 smaller drawers
 Thermopop finish. Lacquer finished front panels
 Length: 710 mm



980830/H Washbasin section with Thermopop worktop. Stainless steel washbasin with chrome mixer tap. Length: 710 mm

980830/H/MAR As above with Marlan worktop

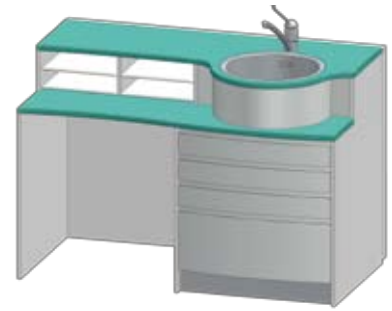

980840/H Combined desk and washbasin section finished in Thermopop Length: 1410 mm

980840/H/MAR As above with Marlan worktop

800105/H Electronically controlled tap with sensor instead of standard chrome mixer tap

815110 Chrome soap dispenser for washbasin section

980850/H Writing desk L-form with Thermopop finish Size according to customer

980850/MAR As above with Marlan finish



980870/H Wall cupboard with 2 convex doors Lighting under cupboard. Length: 710 mm, Depth 370 mm

980880/H Wall cupboard with integrated double X-ray viewer. (Switched on/off from control console of Futurent). Lighting under cupboard Length: 710 mm, Depth 370 mm.

Standard finish

Worktop: white Thermopop laminate (durable and scratch resistant)
 Front panels: Soft-Line lacquer sprayed
 Body: white Thermopop laminate

Standard colours

(front panels)



Blue (RAL 5001)

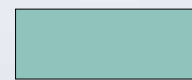

Light green (RAL 6027)

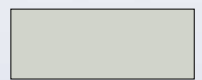

Grey (RAL 7035)

Luxury Marlan

Worktop: Marlan (synthetic marble or granite)
 Front panels: Soft-Line lacquer sprayed
 Body: white Thermopop laminate

Marlan colours

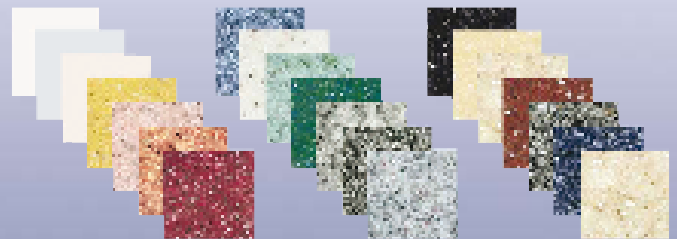

Actual colours may vary from the printed illustrations.

Optional accessories



844072/H

Ear speculum rack



08-355

Binner fibre optic headlight with integrated fibre optic cable



670500

ENTERVIEW II cordless headlight LED-type



844055

Integrated battery charger with hook for ENTERVIEW II



951000

CLAR 55 low-voltage headlight



06000

Ear rinse cup with connection for suction hose

817250

Double dispenser for cotton-wool roll & tongue sheet roll



651000

Frenzel nystagmus glasses



812655

Poltzer olive 18mm, fits directly into compressor handpiece

812665

Poltzer olive 22mm, fits directly into compressor handpiece



150500

Cautery handle & cable



150002

Cautery electrode, loop, fig. 2, 12 cm

150010

Cautery electrode, knife, fig. 10, 12 cm

150012

Cautery electrode, ball, fig. 12, 12 cm

150017

Cautery electrode, needle, fig. 12, 12 cm

We continuously strive to improve and update our products and thus reserve the right to make alterations without prior notice.



entermed

Entermed B.V.

Edisonstraat 22, 8912 AW Leeuwarden, The Netherlands

Tel: +31 58 298 8888, Fax: +31 58 298 8768

info@entermed.com - www.entermed.com